

**Material Features :**

- High-pressure die-casting aluminum back seat, treated with anti corrosion electrostatic powder spraying
- High temperature-proof silicon gasket, Tempered safety glass and High purity aluminum anodized reflector.
- Scale Plates in both sides, Convenient to adjust projecting reflector
- Bulbs changeable in the back opening, easy maintenance

**Applicable places :**

- Illumination of the Stadium ( Football, Cricket, Tennis, Volleyball etc), Golf Course, Race Course, Buildings, Gymnasiums, Docks, Airport, Harbor etc.

IP65 Class I    

**ELGT28-I**

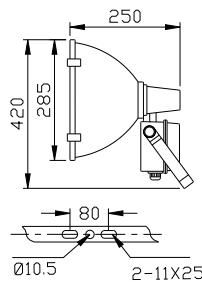

Light Distribution Curve (Cd/1000lm)

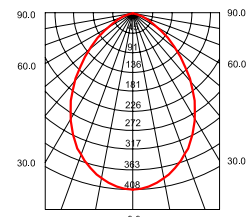

70~150W

**ELGT28-II**

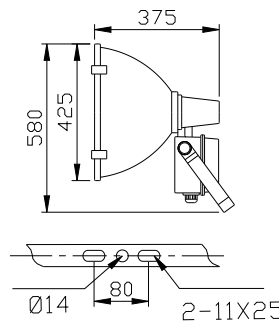

Light Distribution Curve (Cd/1000lm)

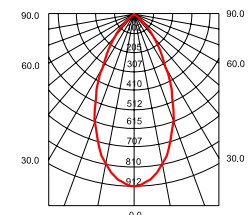

250~400W

**ELGT28-III**

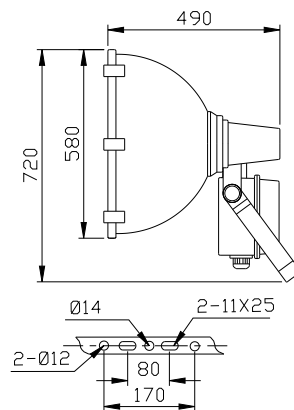

Light Distribution Curve (Cd/1000lm)

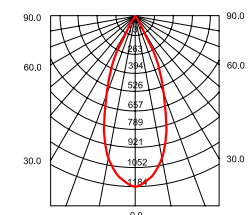

1000W

Model No	Light Source	Power W	Power factor pf	Input Voltage V/Hz	Lamp Type	Lamp Life Hr
ELGT28-I	HPS / MH	70~150	>0.85	220~240V / 50-60Hz	E27/40	24000 / 12000
ELGT28-II	HPS / MH	250~400	>0.85	220~240V / 50-60Hz	E40	24000 / 12000
ELGT28-III	HPS / MH	1000	>0.85	220~240V / 50-60Hz	E40	24000 / 12000